



SUMITOMO ELECTRIC INDUSTRIES, LTD.

ETK1423090

Field Assembly Connector "e-SC" Instruction Manual

Applicable rectangular cable dimension	
type 1	type 2
1.6 +/-0.1 x 2.0 +/-0.1mm	2.0 +/-0.2 x 3.1 +/-0.2mm

For your safety operation

This product has been designed and manufactured to assure personal safety. Improper operation can result in bodily injury and serious damage to this product. Please read and observe all warnings instructions given in this operation manual.

- ★Wear safety glasses before handling optical fiber to protect the eyes. Because the small pieces of glass fibers are very sharp and might get into the eyes, stab a finger and injured them.
- ★Never look into the end of a connector or an optical fiber which may have a laser coupled to it. Laser light might damage your eyes. Please note that laser light is not visible.
- ★In the case of the work at the high place, please be careful not to drop an assembling tool. (Please use a wrist strap etc.)



Precautions

- ①Improper assembly will result in a loss of performance.
- ②The product is sensitive to dust. Do not take out the connector from the package until it is to be used.
- ③The product performance depends on cleaved fiber endface statement. Fiber cleaver shall be maintained properly before using cleaver.
- ④Please insert the fiber into the connector slowly, otherwise fiber might be damaged and cause assembly error. Please also keep safety against scattering broken fiber.
- ⑤Do not remove the dust cap until the connector has been completely assembled in order not to cause an high insertion loss.
- ⑥In case of re-assembling a connector, please be careful to do it to prevent from dust, contamination and so on. Re-assembled connector's performance is under customer's responsibility.

Product Composition

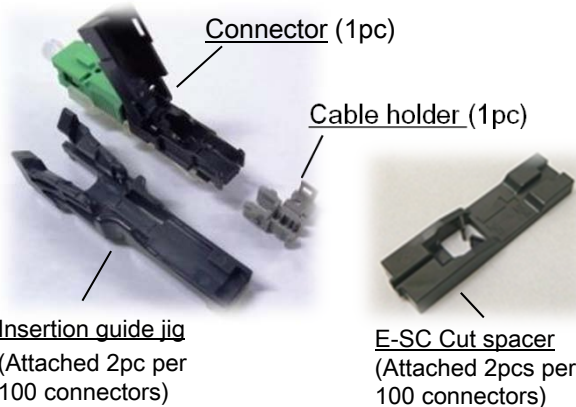

Examples of Assembling tool

Following tools shall be required adding above parts,

①Fiber Cleaver

②Jacket remover

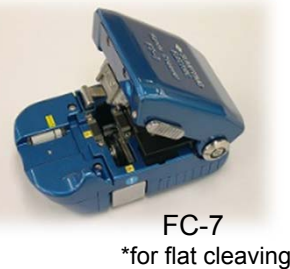

Cable preparation procedure in advance (1-fiber cable and 2-fiber cable)

①Split the cable tip with nipper

②Split cable jacket by hand

③Cut cable jacket

④Cut needless fiber (In case of 2-fiber cable)

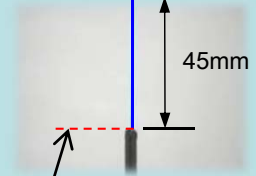
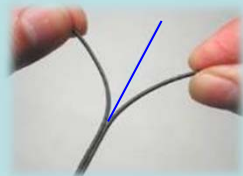

⚠Attention:

Take care not to damage to $\phi 0.25\text{mm}$ fiber to keep good reliability.

Keep equal cutting edge on both cable jacket

Examples

Conventional Outdoor/Indoor Drop Cable

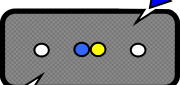

Notch

Low-Friction Outdoor/Indoor Drop Cable



Notch

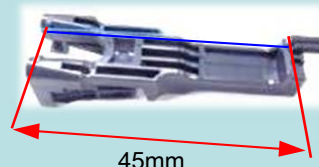

*Attached Insertion guide jig can be used as a scale.

[Contact] Sumitomo Electric Industries, Ltd. Light wave Network Products Division,

TEL +81-45-853-7223 FAX +81-45-851-1286

[1] Set the connector on the Guide jig and preparation of removing cable jacket

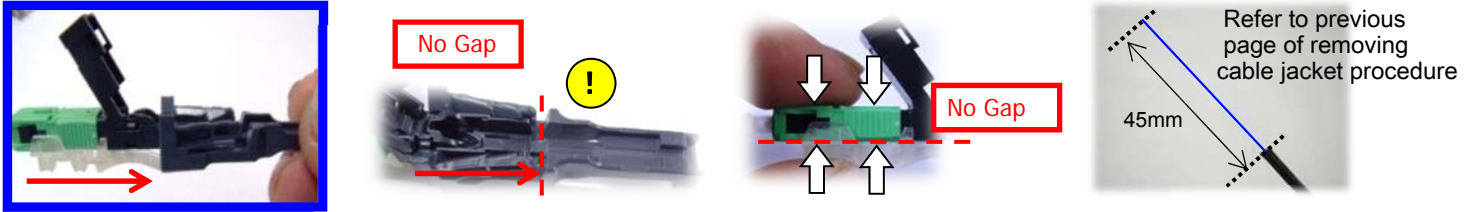

[2] Set the holder on cable-end

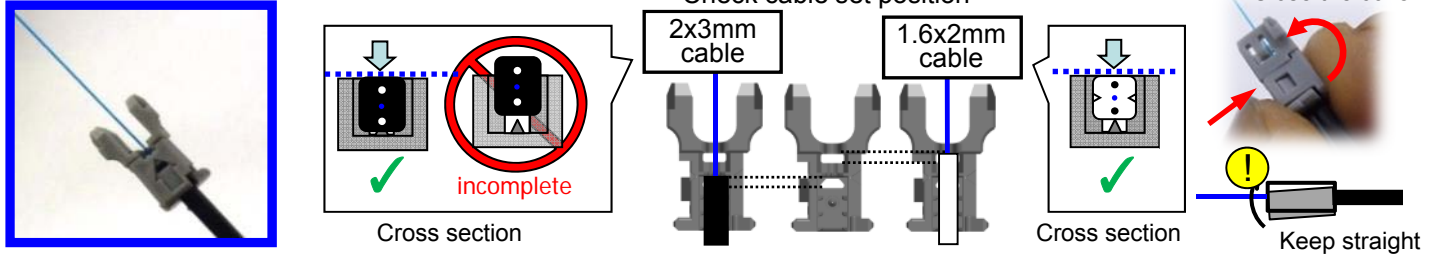

[3] Remove $\phi 0.25\text{mm}$ -fiber jacket



[4] Cleave fiber

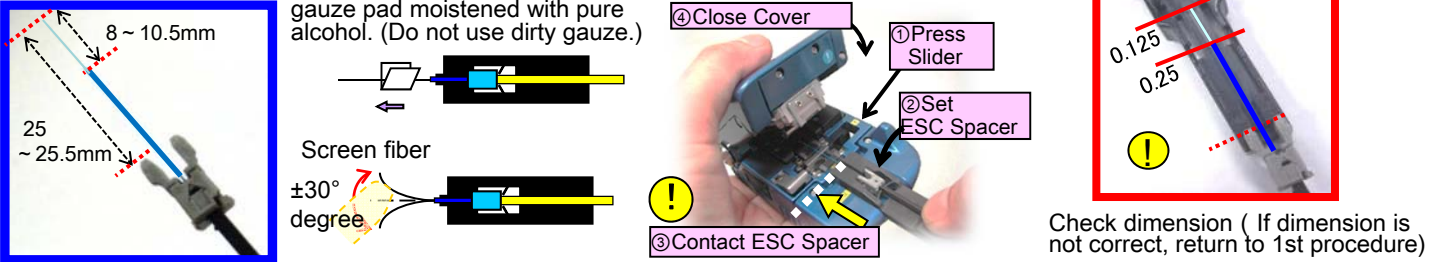

[5] Insert fiber into the connector



[6] Completion

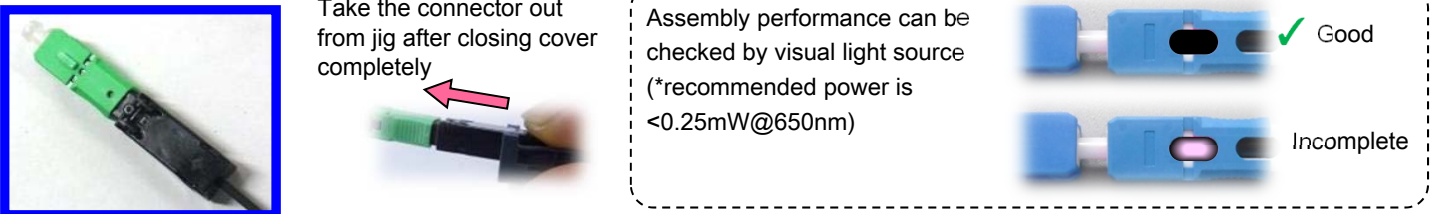

***Re-assemble Procedure**

